

AB-EL16

Alarm Box



Features

- Support through RS485 access to the back-end storage
- Support 16ch Alarm In/6ch Alarm Out interface
- Support 2-bit DIP switch (0/1) to determine the different alarm box access; Max support 4 alarm boxes having access to the back-end storage device
- Support universal 12V power supply; Support using a separate adapter or through 1 to 2 power cable using the DVR adapter to supply the alarm box with power
- The front panel has a power indicator (PWR) which maintains lighting when the device is powered up; The front panel has a signal communication indicator (ACT) which lights up every 1 second when the communication is established between the alarm box and DVR equipment.
- Linked alarm can be configured on the alarm input and output interface when the communication is established between DVR device and the alarm box.

Technical Specification

General

Communication 1 RS485 port

DIP Switch 2-bit

Alarm

Alarm In 16ch

Alarm Out 6ch

Electrical

Power Supply 12V/1A (or use 1 to 2 power cable to use the DVR power)

Power Consumption 0.2W

Environmental

Operating Temperature -10°C ~ +55°C (+14°F ~ +131°F)

Operating Humidity 10%~ 90% RH

Construction

Dimensions 97.68mm×90.3mm×33mm (3.85" x 3.56" x 1.3")

Net Weight ≤0.2kg(0.44lb)

Installation Desktop installation

Certifications

FCC: Coming Soon

CE:Coming Soon

UL:Coming Soon

Dimensions(mm)

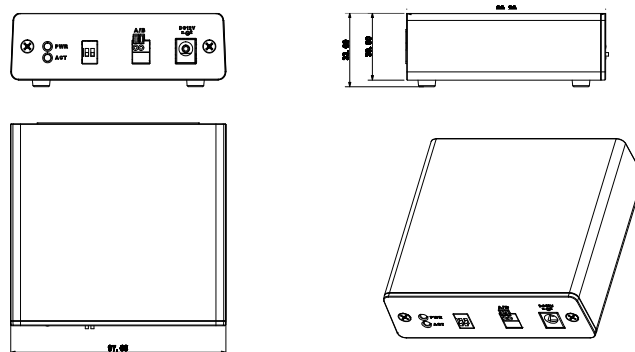

Front Panel

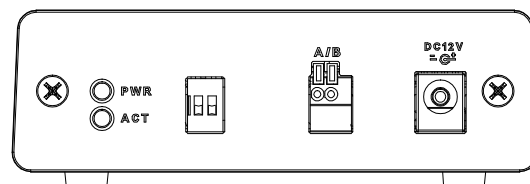

Rear Panel

